

04

Locking System



SYMO 3000 Dead bolt rim lock

Long bolt travel

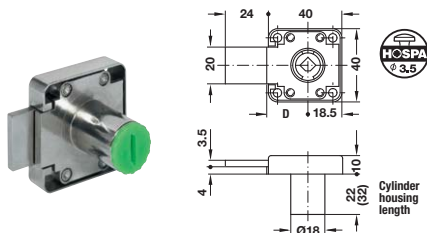

- Area of application: For cylinder cores that are inserted from the front on site
- Material: Zinc die-cast
- Finish: Nickel plated
- Backset D: 22 mm
- Bolt travel: 24 mm
- Cylinder housing length: 22 mm or 32 mm
- Installation: For screw fixing

Locking direction	Cylinder housing length mm	Cat. No.
Left	22	232.25.610
Right		232.25.600
Drawer version	22	232.25.620
(key turn to the right)	32	232.25.680

Packing: 1 or 20 pieces



SYMO 3000 Dead bolt rim lock

Backset 25 mm, short bolt travel

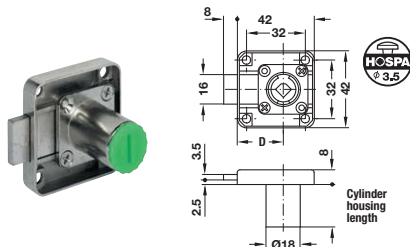

- Area of application: For cylinder cores that are inserted from the front on site
- Material: Zinc die-cast
- Finish: Nickel plated or black
- Backset D: 25 mm
- Bolt travel: 8 mm
- Cylinder housing length: 22 mm (drawer version 22 mm or 32 mm)
- Locking direction: Left, right or drawer version
- Installation: Screw fixing



Zinc die-cast
nickel plated



Zinc die-cast
black

Locking direction	Cylinder housing length mm	Cat. No.
Left	22	232.26.610
Right	22	232.26.601 (With rosette)
Drawer version	22	232.26.620
	26	232.26.651 (With rosette)
	32	232.26.681 (With rosette)

Packing: 1 or 20 pieces

Universal Cylinder core

Individual locking, with key

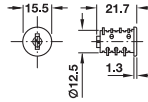

- For use where low security requirements have to be met
- Suitable for standard-duty use

- Area of application: For all locks and lock handles of the Symo system
- Material: Housing: Zinc alloy, plate levers: Brass
- Finish: Nickel plated
- Locking system: With 6 plate levers
- Key change: 2,600 different key changes possible
- Installation: Left hand or right hand, for plug fitting

Supplied with

- 1 Plate cylinder core
- 2 Keys

→ Keyed different, unsorted

Key change	Cat. No.
Keyed different	210.41.613

Packing: 1 or 20 pieces

Order reference

Master key not possible, available unsorted ex warehouse.

→ Keyed different, sorted

Key change	Cat. No.
SH 0601 - 0650	210.41.701
SH 0651 - 0700	210.41.702
SH 0701 - 0750	210.41.703
SH 0751 - 0800	210.41.704
SH 0801 - 0850	210.41.705
SH 0851 - 0900	210.41.706
SH 0901 - 0950	210.41.707
SH 0951 - 1000	210.41.708
SH 1001 - 1050	210.41.709
SH 1051 - 1100	210.41.710
SH 1101 - 1150	210.41.711
SH 1151 - 1200	210.41.712
SH 1201 - 1250	210.41.713
SH 1251 - 1300	210.41.714
SH 1301 - 1350	210.41.715
SH 1351 - 1400	210.41.716
SH 1401 - 1450	210.41.717
SH 1451 - 1500	210.41.718
SH 1501 - 1550	210.41.719
SH 1551 - 1600	210.41.720

Packing: 50 pieces

Order reference

Each package contains 50 cylinder cores out of the specified range of key changes, one piece of each key change.
Suitable master key: MK 3 (Cat. No. 210.11.003)

→ Keyed alike

Key change	Cat. No.
SH 0001	210.40.601
SH 0002	210.40.602
SH 0003	210.40.603
SH 0004	210.40.604
SH 0005	210.40.605
SH 0006	210.40.606
SH 0007	210.40.607
SH 0008	210.40.608
SH 0009	210.40.609
SH 0010	210.40.610
SH 0011	210.40.611
SH 0012	210.40.612
SH 0013	210.40.613
SH 0014	210.40.614
SH 0015	210.40.615
SH 0016	210.40.616
SH 0017	210.40.617
SH 0018	210.40.618
SH 0019	210.40.619
SH 0020	210.40.620
SH 0021	210.40.621
SH 0022	210.40.622
SH 0023	210.40.623
SH 0024	210.40.624
SH 0025	210.40.625
SH 0026	210.40.626
SH 0027	210.40.627
SH 0028	210.40.628
SH 0029	210.40.629
SH 0030	210.40.630
SH 0031	210.40.631
SH 0032	210.40.632
SH 0033	210.40.633
SH 0034	210.40.634
SH 0035	210.40.635
SH 0036	210.40.636
SH 0037	210.40.637
SH 0038	210.40.638
SH 0039	210.40.639
SH 0040	210.40.640
SH 0041	210.40.641
SH 0042	210.40.642
SH 0043	210.40.643
SH 0044	210.40.644
SH 0045	210.40.645
SH 0046	210.40.646
SH 0047	210.40.647
SH 0048	210.40.648
SH 0049	210.40.649
SH 0050	210.40.650

Packing: 1 or 20 pieces

Order reference

Suitable master key: MK 1 (Cat. No. 210.11.001)

Key change	Cat. No.
SH 0051	210.40.651
SH 0052	210.40.652
SH 0053	210.40.653
SH 0054	210.40.654
SH 0055	210.40.655
SH 0056	210.40.656
SH 0057	210.40.657
SH 0058	210.40.658
SH 0059	210.40.659
SH 0060	210.40.660
SH 0061	210.40.661
SH 0062	210.40.662
SH 0063	210.40.663
SH 0064	210.40.664
SH 0065	210.40.665
SH 0066	210.40.666
SH 0067	210.40.667
SH 0068	210.40.668
SH 0069	210.40.669
SH 0070	210.40.670
SH 0071	210.40.671
SH 0072	210.40.672
SH 0073	210.40.673
SH 0074	210.40.674
SH 0075	210.40.675
SH 0076	210.40.676
SH 0077	210.40.677
SH 0078	210.40.678
SH 0079	210.40.679
SH 0080	210.40.680
SH 0081	210.40.681
SH 0082	210.40.682
SH 0083	210.40.683
SH 0084	210.40.684
SH 0085	210.40.685
SH 0086	210.40.686
SH 0087	210.40.687
SH 0088	210.40.688
SH 0089	210.40.689
SH 0090	210.40.690
SH 0091	210.40.691
SH 0092	210.40.692
SH 0093	210.40.693
SH 0094	210.40.694
SH 0095	210.40.695
SH 0096	210.40.696
SH 0097	210.40.697
SH 0098	210.40.698
SH 0099	210.40.699
SH 0100	210.40.700

Plate cylinder, Removable core

→ With key cap

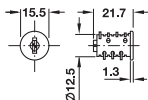

- Area of application: For all locks and rotary handles of the Symo system
- Material : Housing : Zinc alloy, plate levers : Brass
- Finish : Nickel plated
- Locking system : With 6 plate lever
- 3,000 different key changes are possible
- Installation : Left hand or right hand, for plug fitting

Different key

Supplied with

- 1 Plate cylinder removable core
- 2 Keys

Key change	Cat. No.
SH 0001	210.41.623

Packing : 1 or 20 pieces

→ With folding keys

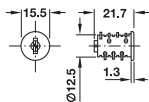

Different key

Supplied with

- 1 Plate cylinder removable core
- 2 Keys

Key change	Cat. No.
SH 0001	210.41.633

Packing : 1 or 20 pieces

Accessories

For Symo Universal plate cylinder removable core

→ Master key

- Material : Steel
- Finish : Nickel plated

Key change	Cat. No.
MK 1 (SH 0201-0600)	210.11.001
MK 3 (SH 0601-2600)	210.11.003

Packing : 1 pieces

→ Removal key

- Material : Steel
- Area of application: For MK system 1 - 3 and for cylinder cores keyed alike or with different key changes

Finish	Cat. No.
Nickel plated	210.11.090

Packing : 1 or 200 pieces

※ 제거키로 코어를 분리



Accessories

For Universal plate cylinder cores

→ Blank key



- Area of application: For duplicate keys or additional keys
- Material: Steel
- Not suitable for removal keys or master keys

Finish	Cat. No.
Nickel plated	210.11.080

Packing: 200 pieces

→ Key cap



- Material: Plastic (soft)
- Colour: Black or grey

Colour	Cat. No.
Grey	210.90.504
Black	210.90.308

Packing: 1 or 100 pieces

→ Cylinder rosette



- Area of application: For covering the edge of the drilled hole for the cylinder housing
- Material: Steel
- Installation: For press fitting

Finish	Cat. No.
Nickel plated polished	219.19.677

Packing: 1 or 100 pieces

Angled striking plate

Screw fixing

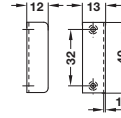

- Material: Steel
- Finish: Nickel plated, brass plated or burnished
- Installation: Screw fixing

Finish	Cat. No.
Nickel plated	239.41.013

Packing: 10 or 100 pcs.

Drill bit for Cylinder rosette

Bohrmax forstner drill bit,
WS bits(schaft length 77mm)



	Cat. No.
19mm	001.04.119

Packing : 1pc

Officys

Magnetic catch

Pull 3–4 kg

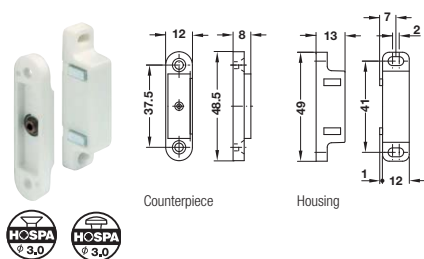

- Material: Plastic housing and counterpiece
- Colour: White or brown
- Pull: 3–4 kg
- Version: Rigid housing, movable counterpiece
- Adjusting facility: With slot
- Installation: Housing and counterpiece for screw fixing

Pull kg	Colour	Cat. No.
3–4	White	246.27.709
	Brown	246.27.101

Packing: 50 pieces



Magnetic double catch

For double doors, pull 2 x 3–4 kg

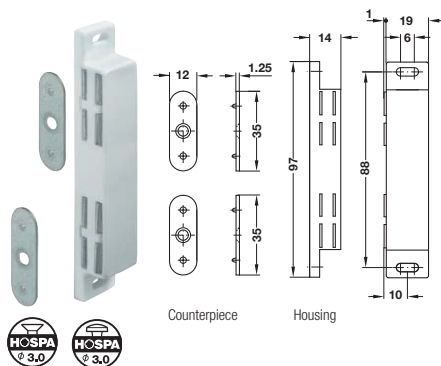

- Area of application: For double doors
- Material: Plastic housing, steel counterpiece
- Colour: Housing white or brown
- Pull: 2 x 3–4 kg
- Version: Movable housing, rigid counterpiece
- Adjusting facility: With slot in the housing
- Installation: Housing and counterpiece for screw fixing

Installation

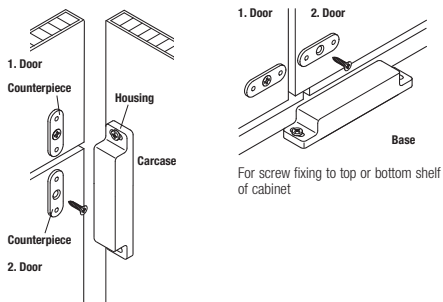

For screw fixing to side panel of cabinet



Plastic white

Colour	Cat. No.
White	246.84.713

Packing: 50 pieces

→ Pull 2.0 kg

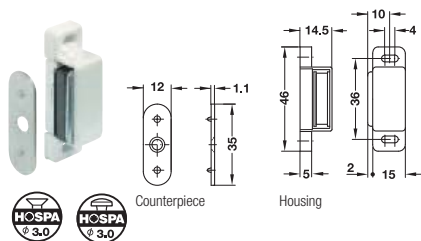

- Material: Housing: Plastic, counterpiece: Steel
- Finish/colour: Housing: White, brown, black or silver coloured, counterpiece: Nickel plated
- Version: Movable housing, rigid counterpiece
- Adjustment facility: With slot in the housing
- Installation: Housing and counterpiece for screw fixing

Colour	Cat. No.	
	Housing	Counterpiece
White	246.26.743	246.26.992
Brown	246.26.142	
Black	246.26.342	
Silver coloured	246.26.950	

Packing: 1 or 100 pieces

→ Pull 3.0 - 4.0 kg or 4.0 - 5.0 kg

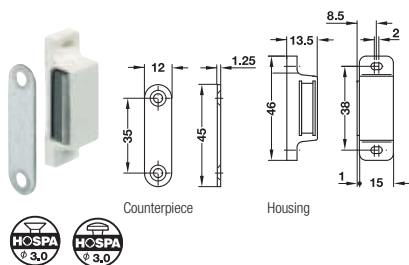

- Material: Housing: Plastic, counterpiece: Steel
- Colour: Housing: White, brown or black
- Version: Movable housing, rigid counterpiece
- Adjustment facility: With slot in the housing
- Adjustment facility: With slot in the housing
- Installation: Housing and counterpiece for screw fixing

Pull kg	Colour	Packing pieces	Cat. No.
3 - 4	White	1 or 50	246.26.720
	Brown	1 or 50	246.26.122
4 - 5	White	1 or 50	246.29.703
	Brown	1 or 50	246.29.105

→ Pull 3.0 - 4.0 kg or 4.0 - 5.0 kg

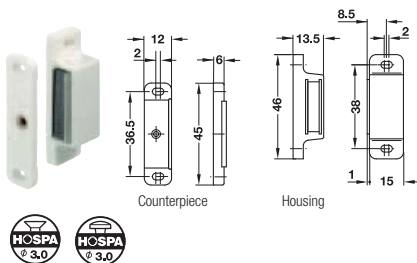

- Material: Housing and counterpiece: Plastic
- Version: Movable housing and counterpiece
- Adjustment facility: With slots in housing and counterpiece
- Installation: Housing and counterpiece for screw fixing

Pull kg	Colour	Cat. No.
3 - 4	White	246.26.711
	Brown	246.26.113
4 - 5	White	246.29.712
	Brown	246.29.114

Packing: 1 or 50 pieces

→ Pull 4.0 kg

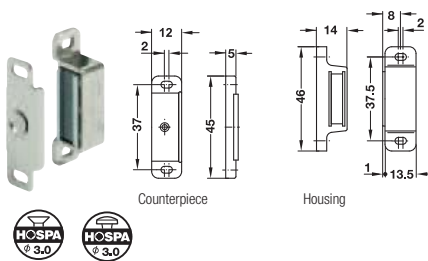

- Material: Housing: Zinc alloy, counterpiece: Metal
- Version: Movable housing and counterpiece
- Adjustment facility: With slots in housing and counterpiece
- Installation: Housing and counterpiece for screw fixing

Finish		Packing pieces	Cat. No.
Nickel plated	Housing	50 or 200	246.94.701
	Counterpiece	1 or 200	246.94.702

Magnetic pressure catch

For glass doors, pull 1.8 kg

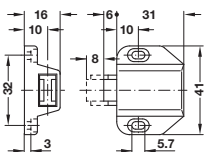

- Area of application: For glass doors
- Material: Plastic
- Colour: Black or white
- Pull: 1.8 kg
- Adjusting facility: With slot
- Installation: Screw fixing

Installation

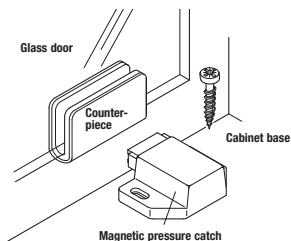

Colour	Cat. No.
White	245.67.710
Black	245.67.310

Packing: 1 or 100 pieces

Order information

Please order counterpieces separately.

Magnetic pressure catch

For double glass doors, pull 2.5 kg

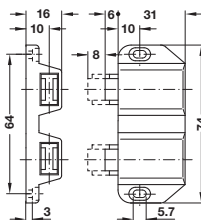

- Area of application: For double-wing glass doors
- Material: Plastic
- Colour: Black or white
- Pull: 2.5 kg
- Adjusting facility: With slot
- Installation: Screw fixing

Installation

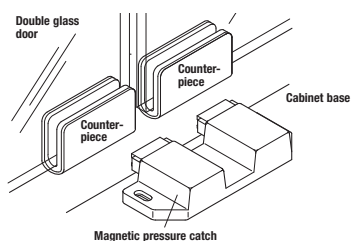

Colour	Cat. No.
Black	245.67.320

Packing: 1 or 50 pieces

Order reference

Please order counterpieces separately.



Counterpiece

Screw fixing

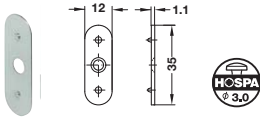

- Material: Steel
- Finish: Galvanized
- Installation: Screw fixing

	Cat. No.
	246.26.793

Packing: 1 or 500 pieces

Counterpiece

Screw fixing

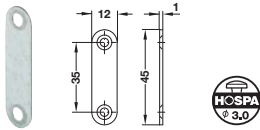

- Material: Steel
- Finish: Galvanized
- Installation: Screw fixing

	Cat. No.
	246.26.991

Packing: 1 or 1,000 pieces

Counterpiece

Knocking in

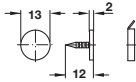

- Material: Steel
- Finish: Galvanized
- Installation: Knocking in

	Cat. No.
	246.08.910

Packing: 1 or 1,000 pieces

Counterpiece

For glass doors, to clip on

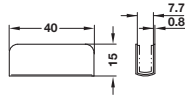

- Area of application: For glass doors
- Material: Steel
- Finish: Chrome plated, nickel plated or black
- For glass thickness: 4–6 mm
- Installation: For clipping on, with self adhesive intermediate layer made of foam material

Finish	Cat. No.
Chrome plated	245.66.201
Nickel plated	245.66.600
Black	245.66.309

Packing: 1 or 400 pieces

Counterpiece

For glass doors, to clip on

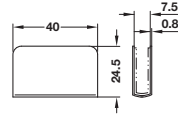

- Area of application: For glass doors
- Material: Steel
- Finish: Chrome plated, nickel plated or black
- For glass thickness: 4–6 mm
- Installation: For clipping on, with self adhesive intermediate layer made of foam material

Installation

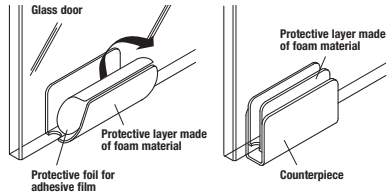

Finish	Cat. No.
Chrome plated	245.66.211
Black	245.66.311

Packing: 1 or 200 pieces

Counterpiece

For glass doors, to clip on, with handle

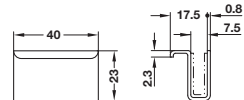

- Area of application: For glass doors
- Material: Steel
- Finish: Chrome plated, nickel plated or black
- For glass thickness: 4–6 mm
- Installation: For clipping on, with self adhesive intermediate layer made of foam material

Finish	Cat. No.
Chrome plated	245.66.221
Black	245.66.321

Packing: 1 or 200 pieces



Steel chrome plated



Steel black

MINI LATCH Spring catch

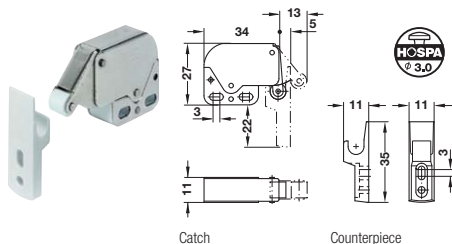

Catch

Counterpiece

- Material: Steel catch, plastic counterpiece
- Finish: Catch nickel plated, counterpiece white
- Installation: Screw fixing
- Adjusting facility: Slot

Installation

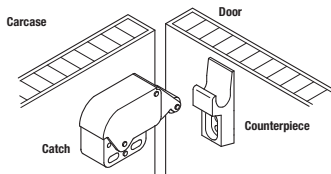

Finish/colour	Cat. No.
Catch: Nickel plated/white, counterpiece: White	245.54.701

Packing: 1, 50 or 400 pcs.

→ Individual spring catch

Finish/colour	Cat. No.
Nickel plated/White	245.54.704
Nickel plated/Black	245.54.304

Packing: 1 or 400 pieces

→ Counterpiece

Material	Finish/colour	Packing piece	Cat. No.
Plastic	White	1 or 400	245.54.790
	Black	1 or 400	245.54.390
Zinc alloy	Bright	1 or 50	245.54.090



QUICK Spring catch

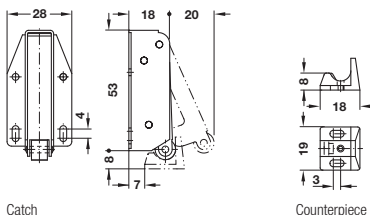

Catch

Counterpiece

- Material: Steel catch, plastic counterpiece
- Finish: Catch bright galvanized, brass plated or burnished, counterpiece white
- Installation: Screw fixing
- Adjusting facility: Slot

Installation

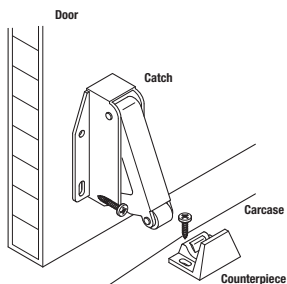

Steel bright galvanized



Steel brass plated



Steel burnished

Finish	Packing pieces	Cat. No.
Bright galvanized	1, 50 or 200	245.55.913
Brass plated	1 or 50	245.55.502
Burnished	1 or 50	245.55.100

→ Counterpiece

Colour	Cat. No.
White	245.55.790

Packing: 1 piece